

TAX MAP

16-1209

Plot Date: February 29, 2008

D

D

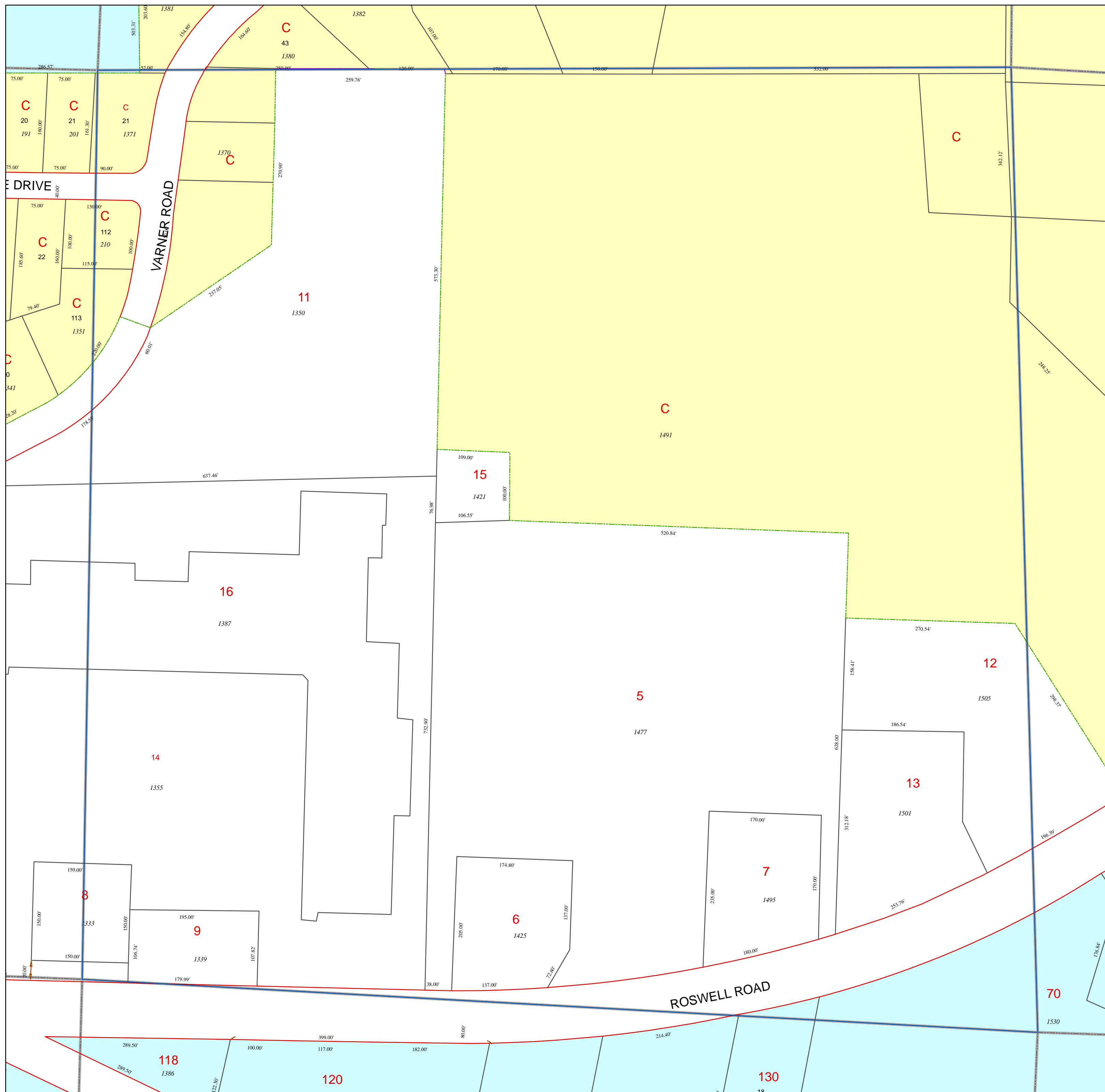

Legend

- Parcel Lines
- Creek Parcel Lines
- City Limit Lines
- ROW Lines
- School Tax Exempt
- Parcels Inside Landlot
- Parcels Outside Landlot
- Cobb County Parcels
- Unidentified Parcels

25 Parcel
15 Lot
1530 Address

Reference Area:

16-1167	16-1168	16-1169
16-1210	16-1209	16-1208
16-1239	16-1240	16-1241

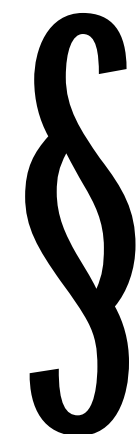

1 = 100 Feet



DISCLAIMER NOTE: This map is prepared for the inventory of real property found within this jurisdiction and is compiled from aerial photography, recorded deeds, plats, and other imagery, data and public records. Users of this map are hereby notified that the aforementioned primary public information sources should be consulted for verification of the information contained on this map. This jurisdiction, and the mapping companies involved in preparing it, assume no legal responsibilities for the information contained on this map.

Coordinate System based on Georgia State Plane System.
West Zone - NAD83

CITY OF Marietta GEORGIA

GIS Department
205 Lawrence Street - Marietta, Georgia 30060
www.mariettaga.gov