

TAX MAP

16-1232

Plot Date: March 23, 2023

Legend

- Parcel Lines
- City Limit Lines
- ROW Lines
- School Tax Exempt
- Parcels Inside Land Lot
- Parcels Outside Land Lot
- Parcels Outside City Limits
- Unidentified Parcels

Reference Area:

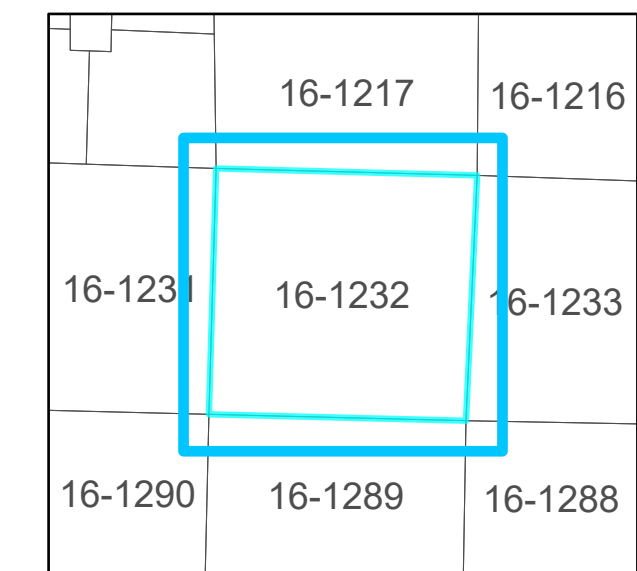

1 Inch = 100 Feet

DISCLAIMER NOTE: This map is prepared for the inventory of real property found within this jurisdiction and is compiled from aerial photography, recorded deeds, plats, and other imagery, data and public records. Users of this map are hereby notified that the aforementioned primary public information sources should be consulted for verification of the information contained on this map. This jurisdiction, and the mapping companies involved in preparing it, assume no legal responsibilities for the information contained on this map.

Coordinate System based on Georgia State Plane System. West Zone - NAD83

CITY OF
Marietta
GEORGIA

GIS Department
205 Lawrence Street - Marietta, Georgia 30060
www.mariettaga.gov

