









# TAX MAP

## 20-0288

Plot Date: March 09, 2026

### Legend

-  Parcel Lines
  -  City Limit Lines
  -  ROW Lines
  -  School Tax Exempt
  -  Parcels Inside Land Lot
  -  Parcels Outside Land Lot
  -  Parcels Outside City Limits
  -  Unidentified Parcels
- 25 Parcel  
 15 Lot  
 1530 Address

### Reference Area:

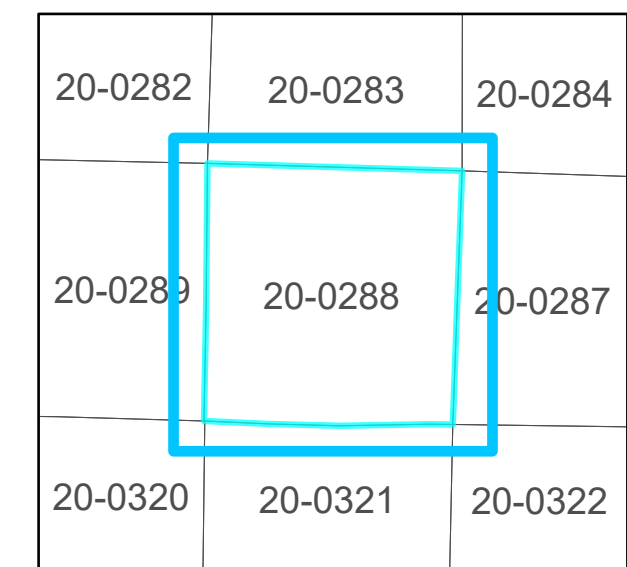

1 Inch  
= 200 Feet

**DISCLAIMER NOTE:** This map is prepared for the inventory of real property found within this jurisdiction and is compiled from aerial photography, recorded deeds, plats, and other imagery, data and public records. Users of this map are hereby notified that the aforementioned primary public information sources should be consulted for verification of the information contained on this map. This jurisdiction, and the mapping companies involved in preparing it, assume no legal responsibilities for the information contained on this map.

Coordinate System based on Georgia State Plane System.  
West Zone - NAD83



GIS Department  
205 Lawrence Street - Marietta, Georgia 30060  
[www.mariettaga.gov](http://www.mariettaga.gov)

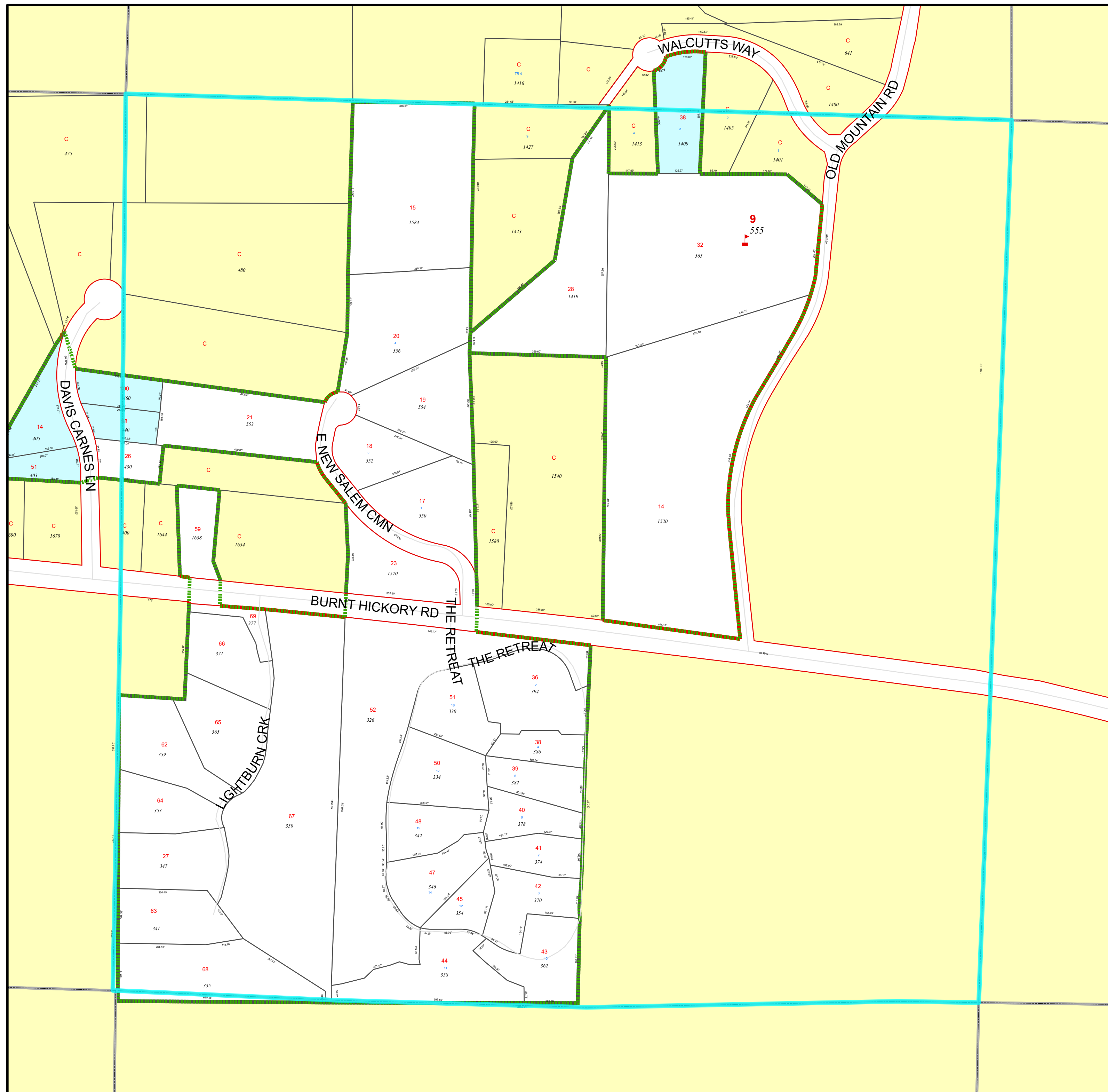

X

X