

L.L. 1217 -16 TH. DIST.

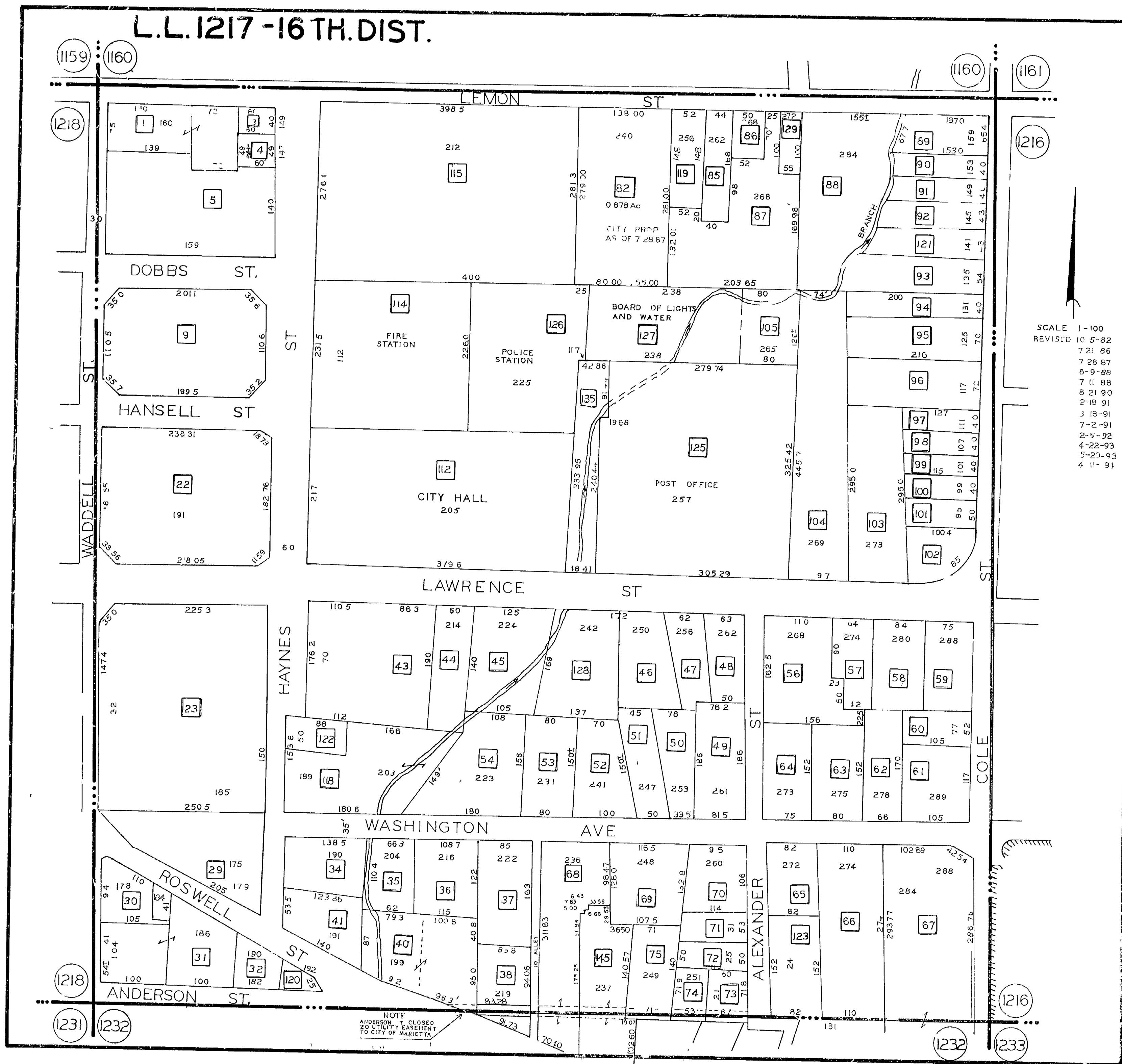

SCALE 1-100
 REVISED
 10-5-82
 7-21-86
 7-28-87
 6-9-88
 7-11-88
 8-21-90
 2-18-91
 3-18-91
 7-2-91
 2-5-92
 4-22-93
 5-23-93
 4-11-91

NOTE
 ANDERSON ST. CLOSED
 TO CITY OF MANHATTAN