

L.L. 1232-16TH DIST.

NOTE WHEN CITY CLOSED ANDERSON ST
THEY KEPT A 20' UTILITY EASEMENT

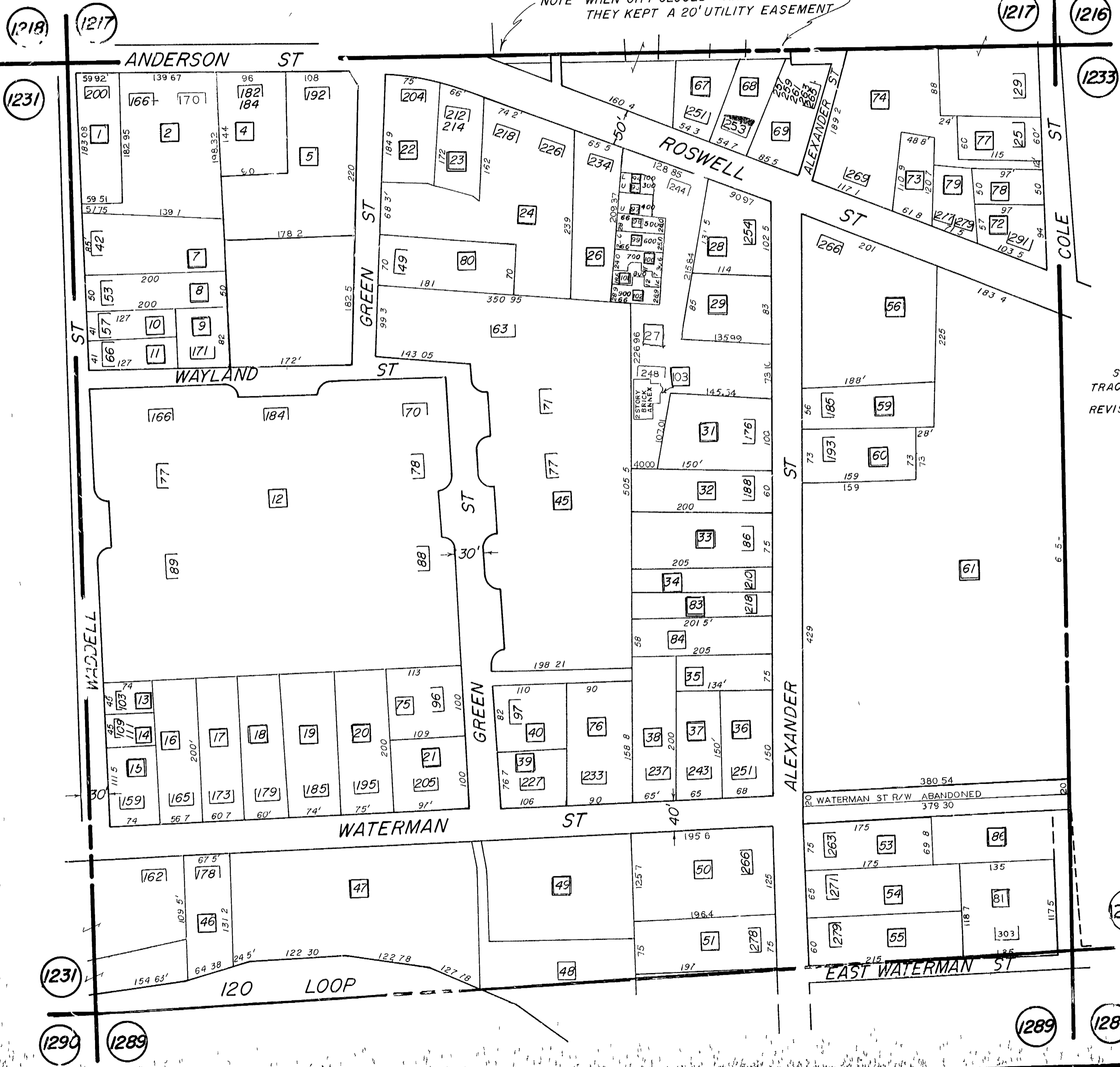

SCALE 1"=100'
 TRACED 11-8-82 JA.
 REVISED 3-24-65
 4 29 87
 7-23 87
 11 11 87
 2 8- 88
 1 18 88
 4 4 89
 6 8- 89
 8-21-90

(1218) (1217) (1231) (1290) (1289)

(1217) (1216) (1233) (1233) (1289) (1288)