

L.L. 1232-16TH DIST.

NOTE WHEN CITY CLOSED ANDERSON ST
THEY KEPT A 20' UTILITY EASEMENT

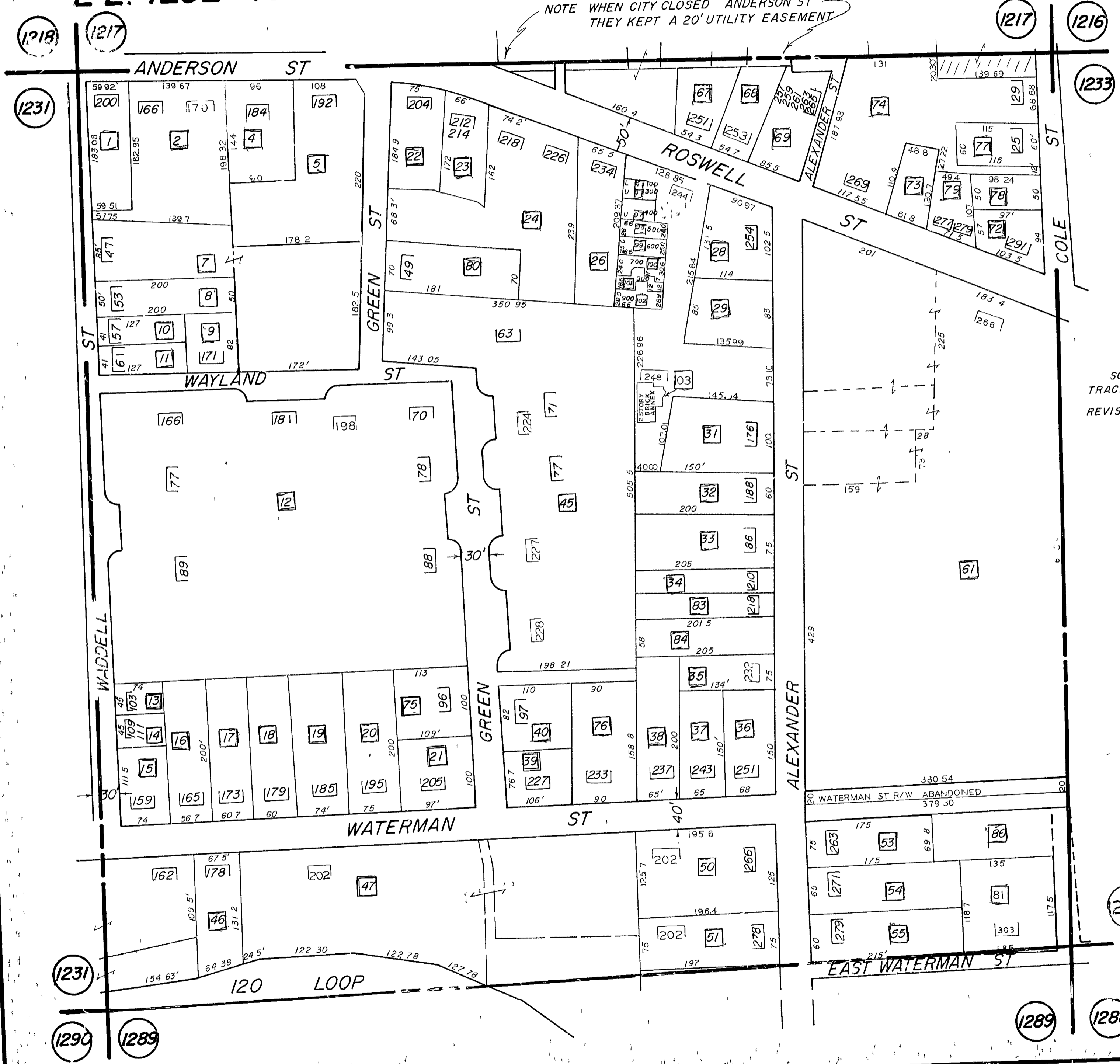

SCALE 1" = 100'
 TRACED 11-8-82 JA.
 REVISED 3-24-85
 4-29-87
 7-23-87
 11-11-87
 2-8-88
 4-18-88
 4-4-89
 6-8-89
 8-21-90
 3-18-90
 7-16-91