

TAX MAP 16-1286

Plot Date: August 13, 2007

Legend

- Parcel Lines
- Creek Parcel Lines
- City Limit Lines
- ROW Lines
- School Tax Exempt
- Parcels Inside Landlot
- 25 Parcel
15 Lot
1530 Address
- Parcels Outside Landlot
- Cobb County Parcels
- Unidentified Parcels

Reference Area:

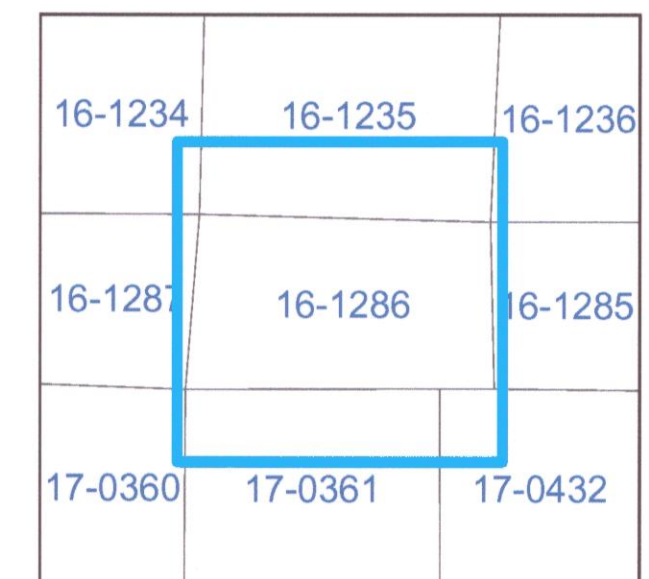

DISCLAIMER NOTE: This map is prepared for the inventory of real property found within this jurisdiction and is compiled from aerial photography, recorded deeds, plats, and other imagery, data and public records. Users of this map are hereby notified that the aforementioned primary public information sources should be consulted for verification of the information contained on this map. This jurisdiction, and the mapping companies involved in preparing it, assume no legal responsibilities for the information contained on this map.

Coordinate System based on Georgia State Plane System.
West Zone - NAD83



Map Correction
for parcel 45
+ 112

split out of 52
Switch Addresses
to match tax
map, Plat
Thanks!



GIS Department
205 Lawrence Street - Marietta, Georgia 30060
www.marietta.ga.gov