

TAX MAP 16-1291

Plot Date: Aug 11, 2005

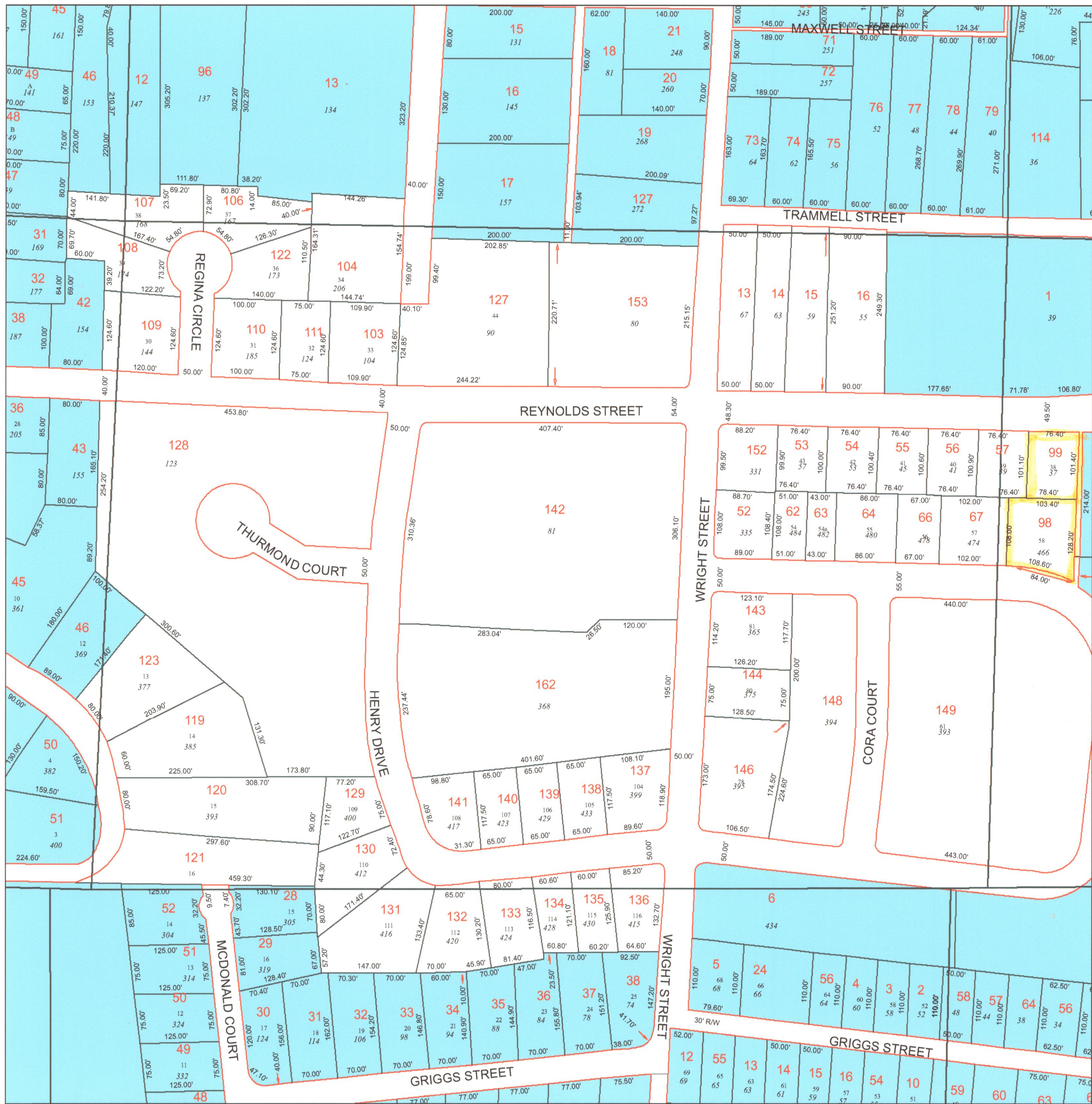

Legend

- Parcel Lines
- Creek Parcel Lines
- City Limit Lines
- ROW Lines
- School Tax Exempt
- Parcels Inside Landlot
- Parcels Outside Landlot
- Cobb County Parcels
- Unidentified Parcels

Reference Area:

16-1220	16-1219	16-12184
16-1229	16-1230	16-1231
16-1292	16-1291	16-1290
17-0145	17-0216	17-0217
17-0146	17-0215	17-0218



DISCLAIMER NOTE: This map is prepared for the inventory of real property found within this jurisdiction and is compiled from aerial photography, recorded deeds, plats, and other imagery, data and public records. Users of this map are hereby notified that the aforementioned primary public information sources should be consulted for verification of the information contained on this map. This jurisdiction, and the mapping companies involved in preparing it, assume no legal responsibilities for the information contained on this map.

Coordinate System based on Georgia State Plane System.
West Zone - NAD83

Marietta
GIS Department
205 Lawrence Street - Marietta, Georgia 30060
www.mariettaga.gov