

TAX MAP 17-0008

Plot Date: December 1, 2006

Legend

- Parcel Lines
- Creek Parcel Lines
- City Limit Lines
- ROW Lines
- School Tax Exempt
- Parcels Inside Landlot
- Parcels Outside Landlot
- Cobb County Parcels
- Unidentified Parcels

25 Parcel
15 Lot
1530 Address

Reference Area:

19-0259	17-0007	17-0066
19-0260	17-0008	17-0065
19-0333	17-0009	17-0064



1 = 100 Feet

DISCLAIMER NOTE: This map is prepared for the inventory of real property found within this jurisdiction and is compiled from aerial photography, recorded deeds, plats, and other imagery, data and public records. Users of this map are hereby notified that the aforementioned primary public information sources should be consulted for verification of the information contained on this map. This jurisdiction, and the mapping companies involved in preparing it, assume no legal responsibilities for the information contained on this map.

Coordinate System based on Georgia State Plane System.
West Zone - NAD83

GIS Department
205 Lawrence Street - Marietta, Georgia 30060
www.mariettaga.gov

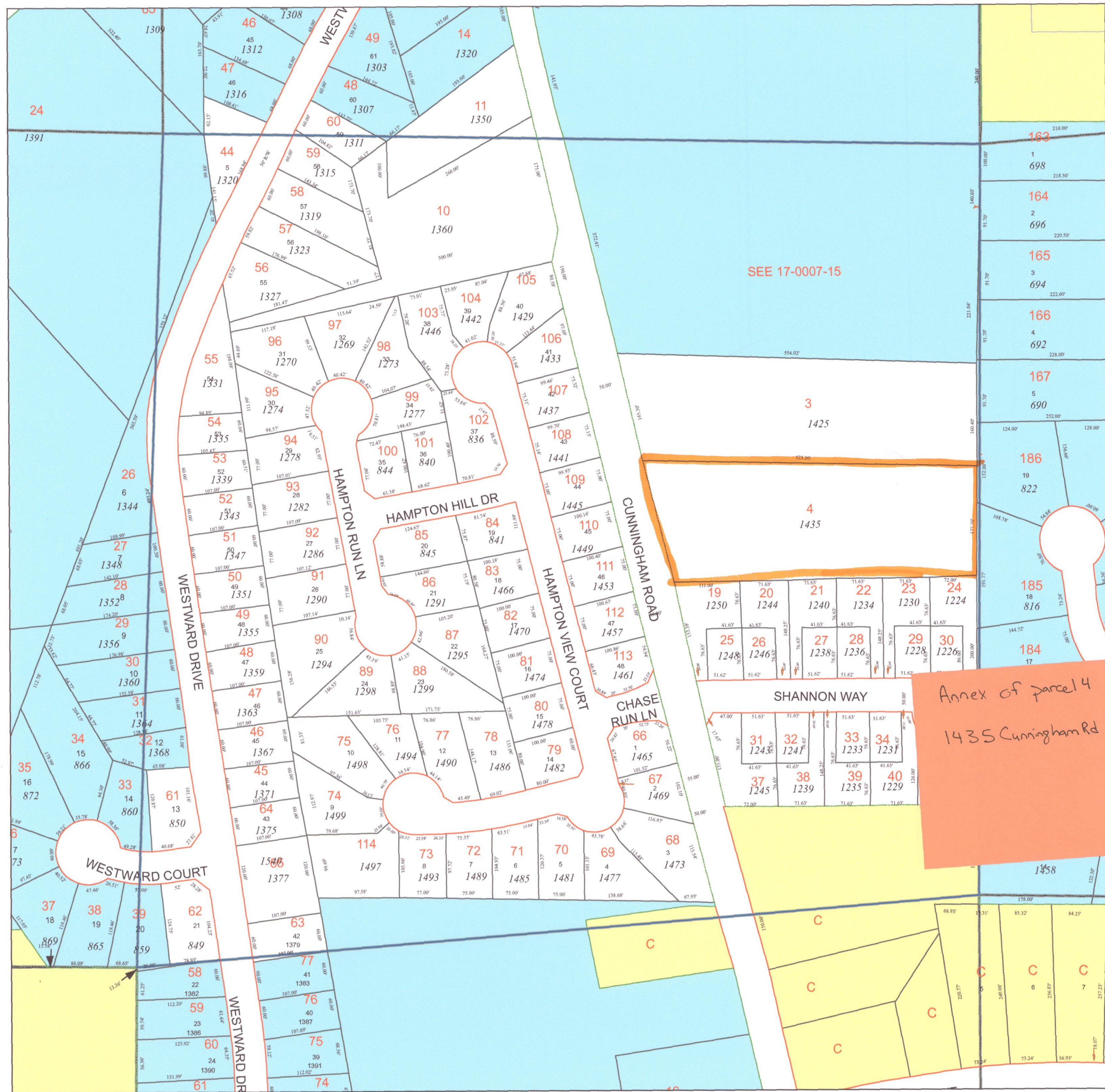

*Annex of parcel 4
1435 Cunningham Rd*