

TAX MAP 20-0323

Plot Date: Aug 08, 2005

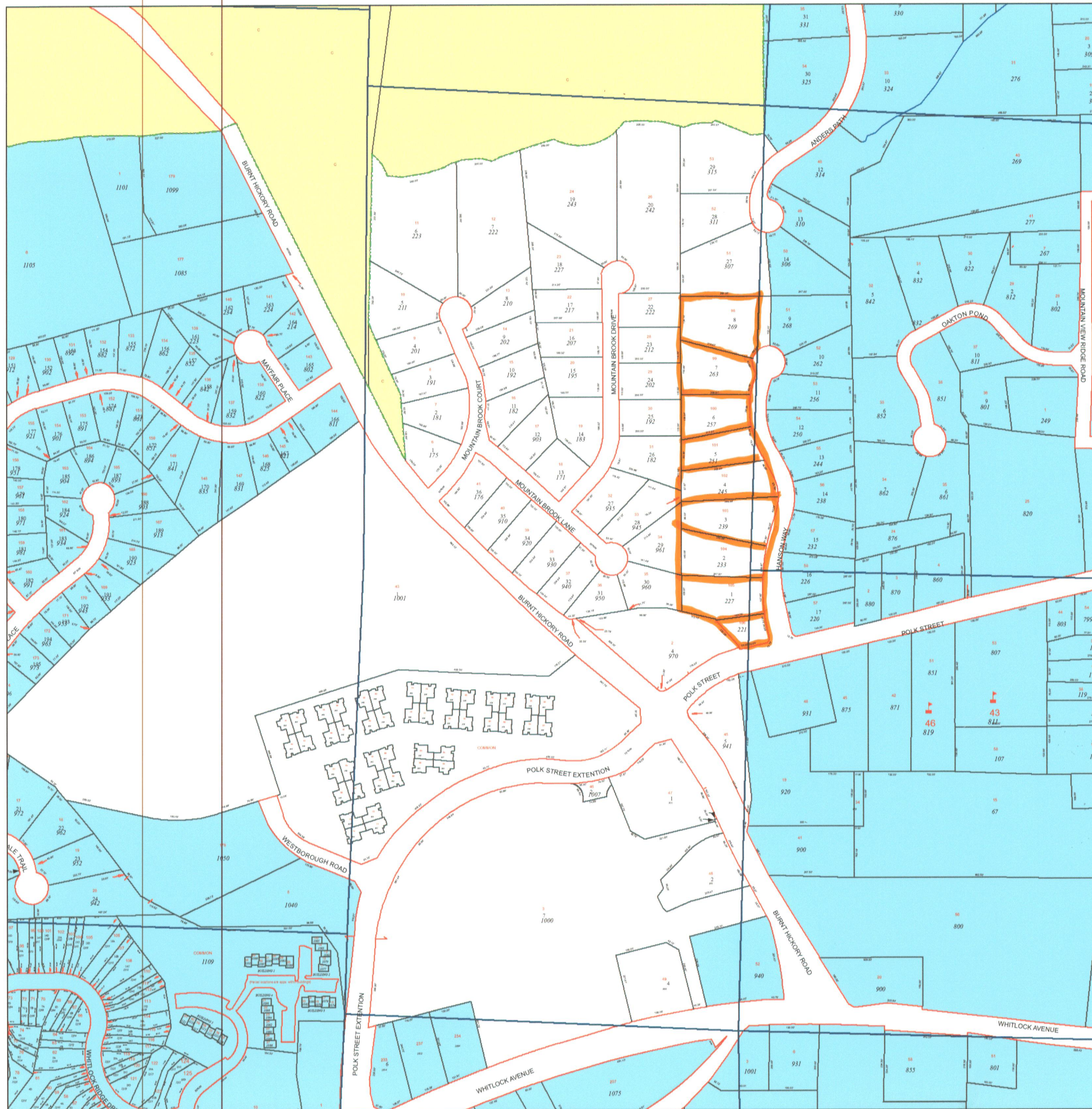

Legend

- Parcel Lines
- Creek Parcel Lines
- City Limit Lines
- ROW Lines
- ▲ School Tax Exempt
- Unidentified Parcels
- Parcels Inside Landlot
- 25 Parcel
- 15 Lot
- 1530 Address
- Parcels Outside Landlot
- Cobb County Parcels

Reference Area:

20-0288	20-0287	20-0286	16-1081
			16-1152
20-0321	20-0322	20-0323	16-1153
			16-1224
20-0326	20-0325	20-0324	16-1225

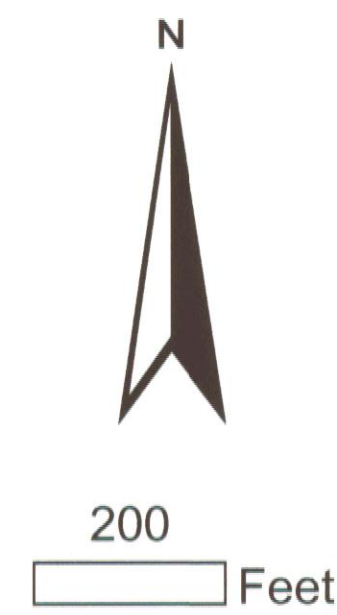

DISCLAIMER NOTE: This map is prepared for the inventory of real property found within this jurisdiction and is compiled from aerial photography, recorded deeds, plats, and other imagery, data and public records. Users of this map are hereby notified that the aforementioned primary public information sources should be consulted for verification of the information contained on this map. This jurisdiction, and the mapping companies involved in preparing it, assume no legal responsibilities for the information contained on this map.

Coordinate System based on Georgia State Plane System.
West Zone - NAD83



Marietta
GIS Department
205 Lawrence Street - Marietta, Georgia 30060
www.mariettaga.gov