

×

×

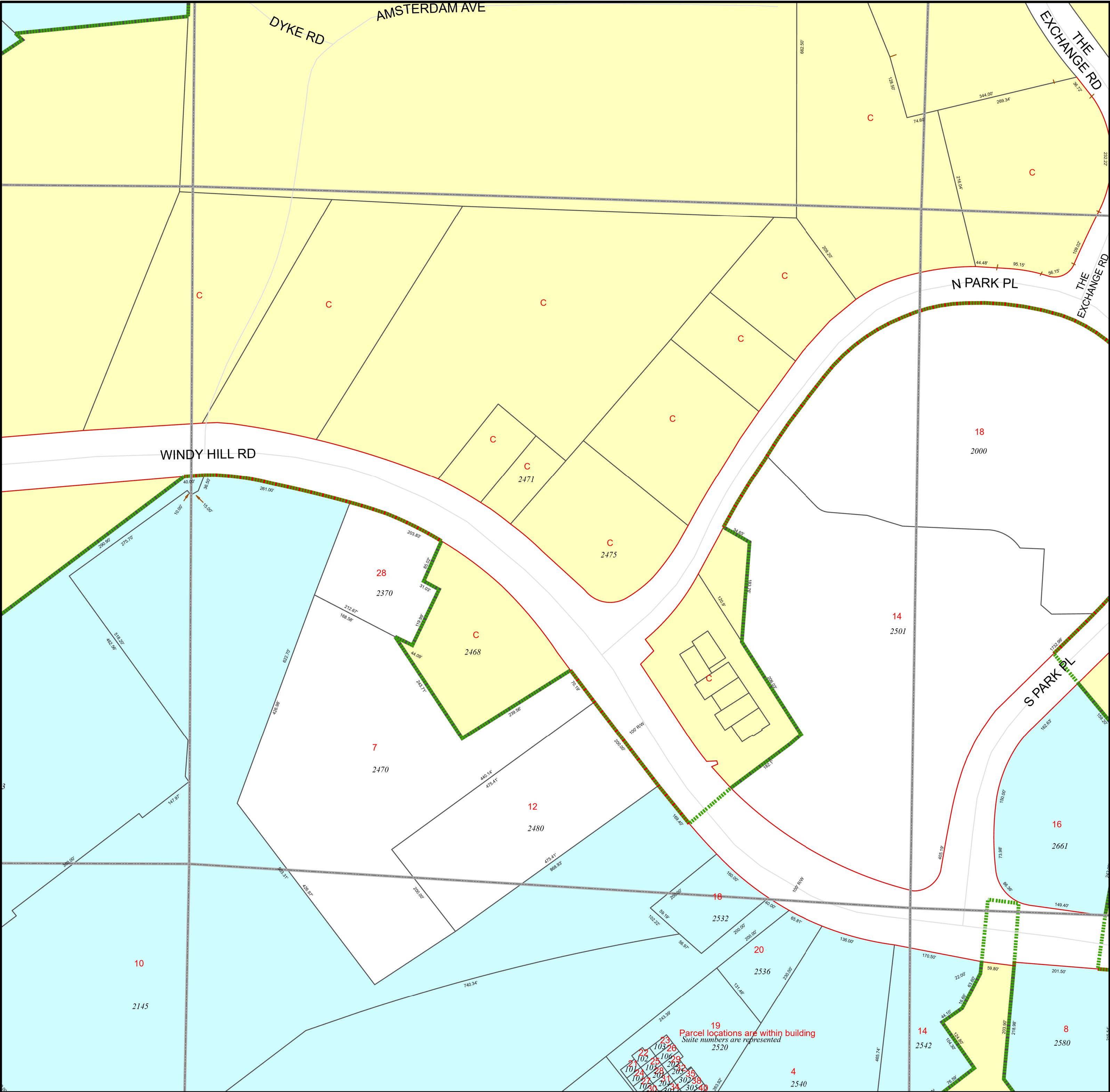

TAX MAP

17-0804

Plot Date: May 27, 2025

Legend

- Parcel Lines
- City Limit Lines
- ROW Lines
- School Tax Exempt
- Parcels Inside Land Lot
- 25 Parcel
- 15 Lot
- 1530 Address
- Parcels Outside Land Lot
- Parcels Outside City Limits
- Unidentified Parcels

Reference Area:

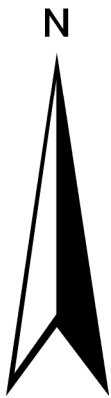
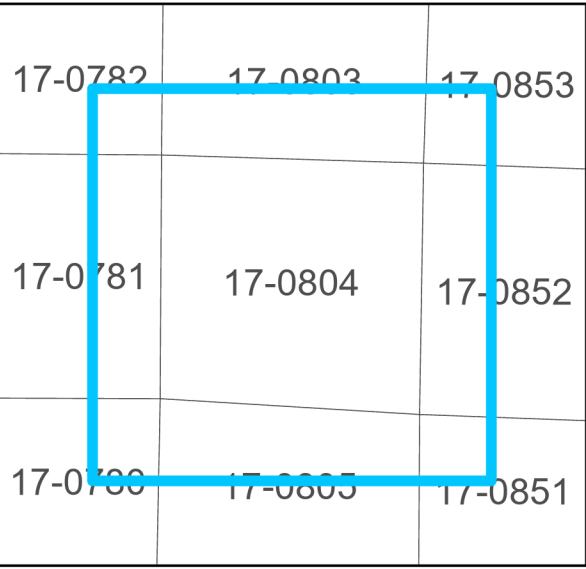

1 Inch
= 100 Feet

DISCLAIMER NOTE: This map is prepared for the inventory of real property found within this jurisdiction and is compiled from aerial photography, recorded deeds, plats, and other imagery, data and public records. Users of this map are hereby notified that the aforementioned primary public information sources should be consulted for verification of the information contained on this map. This jurisdiction, and the mapping companies involved in preparing it, assume no legal responsibilities for the information contained on this map.

Coordinate System based on Georgia State Plane System.
West Zone - NAD83



GIS Department

205 Lawrence Street - Marietta, Georgia 30060

www.mariettaga.gov

Parcel locations are within building
Suite numbers are represented